

LENCO ELECTRIC ACTUATORS



INSTANT RESPONSE ELECTRIC ACTUATORS ARE MADE OF HIGH IMPACT GLASS FIBER FILLED, ULTRAVIOLET-RESISTANT NYLON MATERIAL WITH 316 SUPER BUFF STAINLESS STEEL TUBING.

► OUR IMPROVED ACTUATORS

- 1 Stronger top cap and mounting clevis design.
- 2 New & improved pressure-tight torx screws.
- 3 Integrated wiper seal at actuator base.
- 4 Molded-in brass thrust bearing design.
- 5 Thicker and stronger motor housing wall.
- 6 Improved O-Ring design for a more consistent seal.
- 7 Over-molded cable providing a stronger tighter seal.
- 8 Upper mounting bracket w/ gland seal.

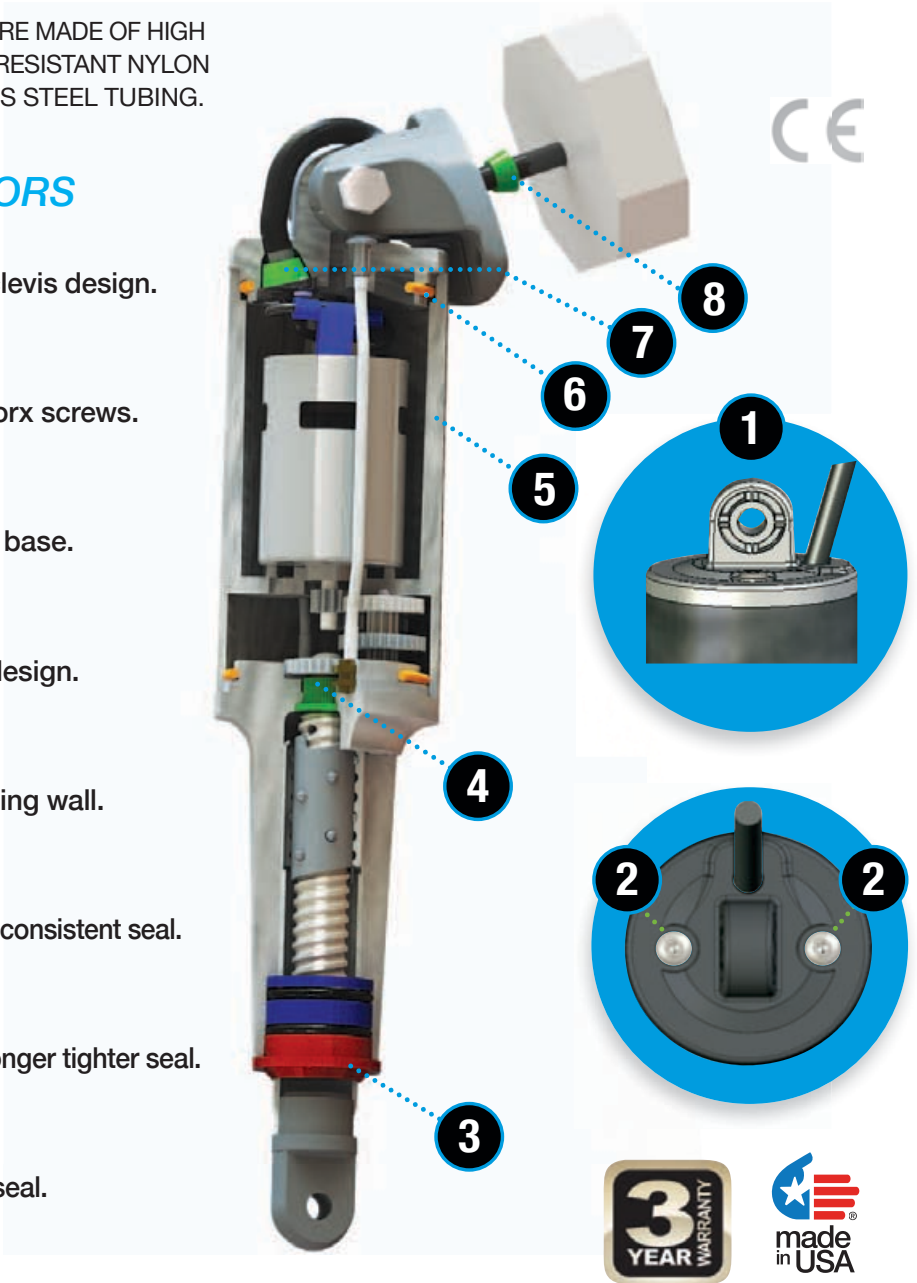

► FEATURES

Lenco's ballscrew design is more reliable and twice as powerful compared to typical hydraulics.

Lenco's tough, high-torque actuator motor easily pushes 750 lbs. (340 kg) Available in 12 or 24-Volts.

Lenco Actuator connections use waterproof "Plug & Play" Deutsch connectors eliminating the possibility of water intrusion.

LENCO ELECTRIC ACTUATORS 12 & 24-Volt Models

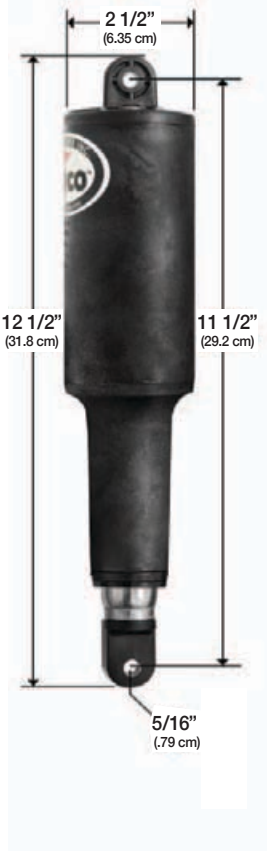

101 Standard Actuator
2 1/4" Stroke (5.715 cm)

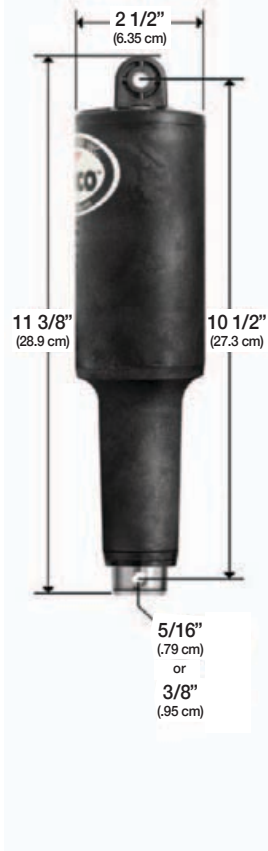

101 XD Actuator
2 1/4" Stroke (5.715 cm)

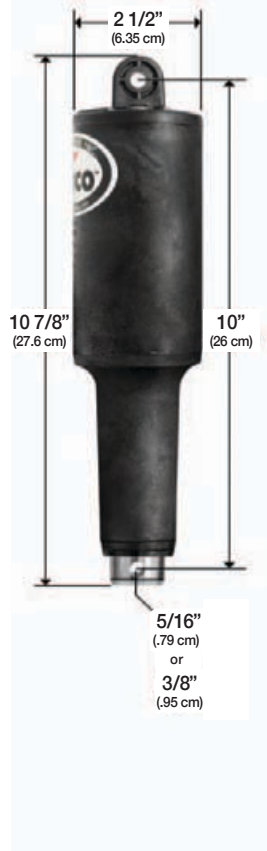

101 XDS (Short) Actuator
2 1/4" Stroke (5.715 cm)

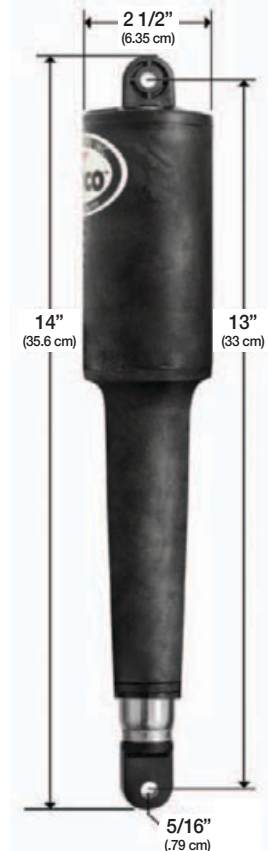

102 Actuator
4 1/4" Stroke (10.795 cm)

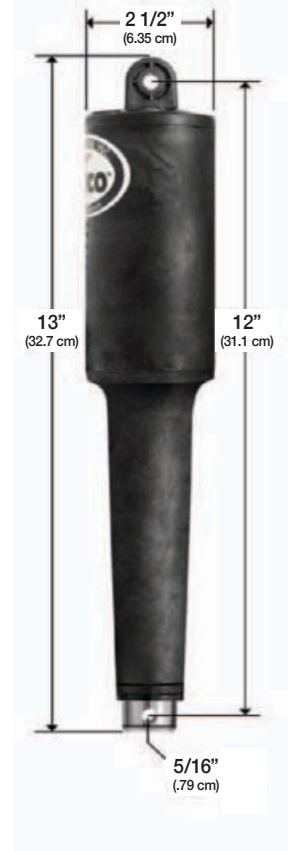

102 HD/XD Actuator
4 1/4" Stroke (10.795 cm)

The 101 Actuator is used in all Standard, Edge Mount and Standard Performance kits. 2 1/4" stroke - Overall length tip to tip = 12 1/2 inches.

The 101 XD Actuator is used mostly with HD, XD, High Performance & Super Strong tabs. 2 1/4" stroke Overall length tip to tip = 11 3/8 inches.

The 101 XDS Actuator is used with OEM specific kits & limited space applications; it is the shortest actuator we manufacture. 2 1/4" stroke - Overall length tip to tip = 10 7/8 inches.

The 102 Actuator is used with Trolling Tab systems sold prior to 2000 and OEM applications. 4 1/4" stroke. Overall length tip to tip = 14".

The 102 HD Actuator is used with Trolling Tab systems sold after 2000 and OEM applications. 4 1/4" stroke. Overall length tip to tip = 13 inches.

15054-001
12-volt actuator with 5/16" mounting hardware with 6' cable

15055-001
12-volt, 5/16" mounting hardware with 6' cable

15057-001
12-volt, 5/16" mounting hardware with 6' cable

15059-001
12-volt, 5/16" mounting hardware with 6' cable

15060-001 (102 HD)
12-volt, 5/16" mounting hardware with 6' cable. (Shown above)

15061-001
24-volt actuator with 5/16" mounting hardware with 6' cable

15062-001
24-volt, 5/16" mounting hardware with 6' cable

15058-001
12-volt, 3/8" mounting hardware with 6' cable

15066-001
24-volt, 5/16" mounting hardware with 6' cable

15131-001 (102 HD)
24-volt, 5/16" mounting hardware with 6' cable

15056-001
12-volt, 3/8" mounting hardware with 6' cable

15063-001
24-volt, 3/8" mounting hardware with 6' cable

15056-002
(12-volt, 5/16" upper & 3/8" lower mounting hardware with 6' cable)

15063-002
(24-volt, 5/16" upper & 3/8" lower mounting hardware with 6' cable)



Scan QR code or visit us at lencomarine.com

Replacement Actuators are packaged with Deutsch connectors and all stainless steel mounting hardware.

The entire Actuator is fully submersible, maintenance-free and sealed for life with a 3 year warranty.



102 XD Actuator
4 1/4" Stroke (10.795 cm)

15067-001 (102 XD)
Similar to 15060-001 24-volt, 5/16" mounting hardware with 6' cable & an overall length tip to tip of 13 1/4" inches. (Not shown)