

ITEM	PART NUMBER	DESCRIPTION	QTY
1	P22-HSGHR2500A	HOUSING ALLOY HR2500 CHEETAH SG/SC	1
2	K06-SFTHR2500A	SHAFT ASSEMBLY HR2500 CHEETAH SG/SC	1
3	P07-CLNBRZHR01200C	CLUTCH NUT BRONZE HR1200 COUGAR 3 PRONG	1
4	P08-CNEBRZHR01200CD	'D' CONE BRONZE HR1200C COUGAR	1
5	P11-HANAB2LEV01200C	HANDLE LEVER AB2 HR1200C COUGAR	1
6	P02-NOVHR01200CLH	BEARING LEVER HANDLE NOV HR1200C COUGAR	1
7	P22-BPLALLHR02500	BASE PLATE ALLOY HR2500 CHEETAH	1
8	P02-NOVHR01200CCS	BEARING CAPSTAN SIDE NOV HR1200C COUGAR	1
9	P02-GSH035.0025.052	SPACER GUARDSHAFT HR1200C CAPSTAN	1
10	P04-CAPBRZ01200C	CAPSTAN BRONZE HR1200C COUGAR	1
11	P21-BRS031.8009.503	WASHER BRASS 1-1/4" X 3/8" X 3MM	1
12	S36-30409.52025	SCREW HEX HD SS304 3/8 INCH X 1 INCH	1
13	S45-30407.94013	SCREW SHCS SS304 5/16 X 0-1/2 INCH	1
14	P13-BRZLEVHR1200C	PAWL LEVER HANDLE HR1200C COUGAR	1
15	S13-30409.52038	BOLT HEX HD SS304 0-3/8 X 1-1/2 INCH	1
16	P02-303013.5009.314	BUSH SS303 HR1200C COUNTERWEIGHT PAWL	1
17	P13-BRZCWGHR1200C	PAWL COUNTERWEIGHT HR1200C COUGAR	1
18	S36-30409.52013	SCREW HEX HD SS304 3/8 X 0-1/2 INCH	1
19	S75-30409.52025	WASHER FLAT SS304 3/8 INCH 1 LGE/OD	1
20	P02-NYL025.0010.517	BUSH NYLON HR1200C COUGAR FOOT	4
21	P11-HAN304EXHR1200C	HANDLE EXTENSION 304 HR1200C COUGAR	1
22	S33-30404.76013	SCREW CSK SL MT 304 0-3/16 X 0-1/2 INCH	6
23	R41-ORG04203503.5	'O' RING SEAL 42X35X3.5 (BS220)	2
24	S33-30406.35025	SCREW CSK SL MT 304 0-1/4 X 1 INCH	2
25	S75-30409.52019	WASHER FLAT SS304 3/8 INCH X 0-3/4 INCH	2
26	S76-30409.52	WASHER SPRING SS304 3/8 INCH	1

A: GYPSY
 B: MOTOR / GEARBOX ASSEMBLY

MUIR WINDLASSES AUSTRALIA

TITLE
 HR2500 COMPACT / SINGLE GYPSY/CAPSTAN
 EXPLODED VIEW / CAPSTAN TO PORT

PART No.
 K08-COMHR2500 (CHEETAH)

DRN AC	DATE 07/04/02	DRG No. K08-COMHR2500
SCALE NTS	APP1	APP2
SIZE A4		

© COPYRIGHT MUIR ENGINEERING PTY. LTD.

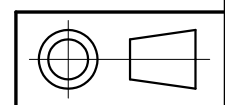

TOLERANCES (mm)

X. ±

X.X ±

X.XX ±

UNLESS OTHERWISE SPECIFIED

MATERIAL

FINISH